

SPARSH VP210
Quick Start

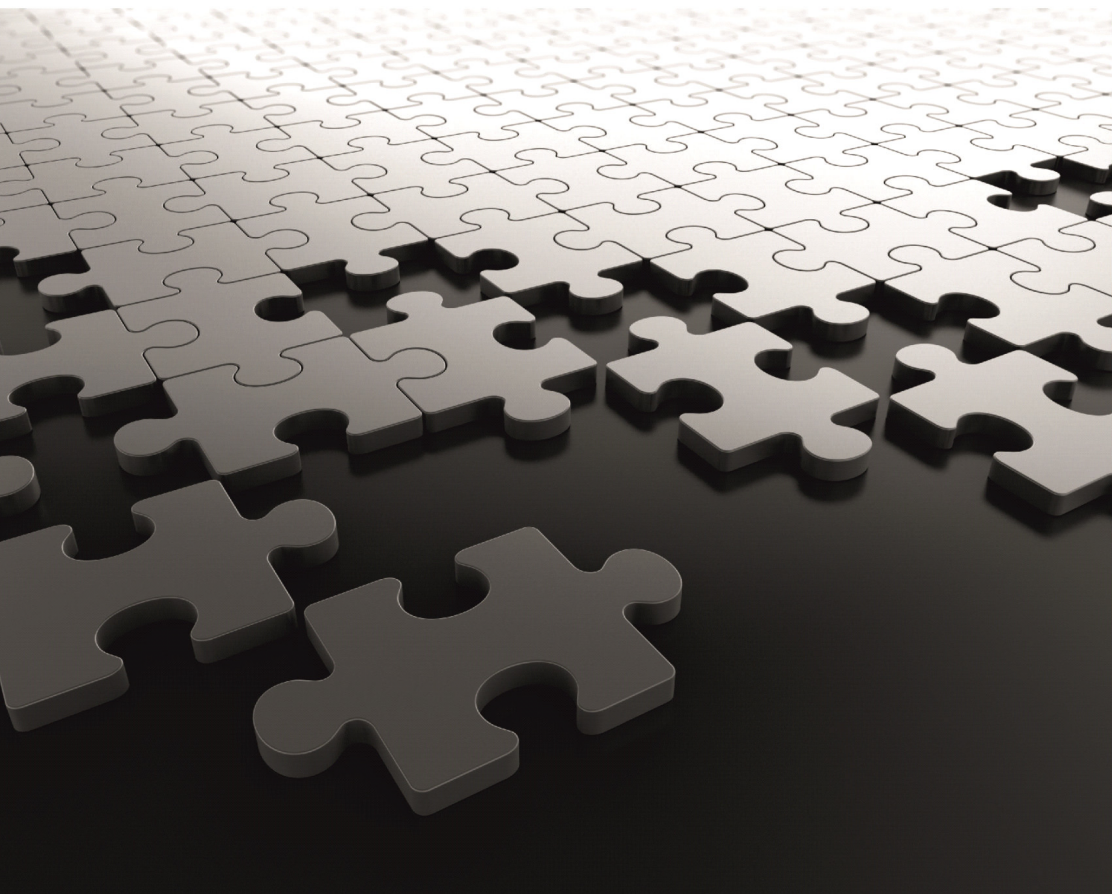

Disclaimer

Matrix Comsec reserves the right to change, at any time, without prior notice, the product design, specifications, components, as engineering and manufacturing may warrant.

This is a general documentation for all models/configurations of the product. The product may not support some of the features/facilities described in this document.

While every reasonable effort has been made to ensure accuracy of content in this document, Matrix Comsec assumes no responsibility for errors or omissions that may occur herein. No liability is assumed for damages, costs, expenses resulting from unauthorized modifications or repairs to the product; failure to use information or to comply with the installation, operation and maintenance instructions contained in this document.

Copyright

All rights reserved. No part of this document may be copied or reproduced in any form or by any means without the prior written consent of Matrix Comsec.

Version 1

Release date: December 20, 2021



SPARSH VP210

Entry Level IP Phone

Quick Start



Package Contents

- SPARSH VP210 Phone
- Handset with Handset Cord
- Ethernet Cable
- A Foot Stand

Contents

<i>Know Your SPARSH VP210</i>	<i>5</i>
<i>Installing SPARSH VP210</i>	<i>8</i>
<i>Connecting SPARSH VP210</i>	<i>10</i>
<i>Configuring SPARSH VP210</i>	<i>13</i>
<i>Converting SPARSH VP210 Extended SIP Phone to SPARSH VP210 Standard SIP Phone</i>	<i>17</i>
<i>Converting SPARSH VP210 Standard SIP Phone to SPARSH VP210 Extended SIP Phone</i>	<i>18</i>

Thank you for choosing SPARSH VP210! Please read this guide first for correct installation and retain it for future reference. The information in this guide was current at the time of publication. All specifications are subject to change without notice.



This Quick Start is meant to help you install and connect the phone to make and receive calls. For detailed instructions, refer to the User Guide.

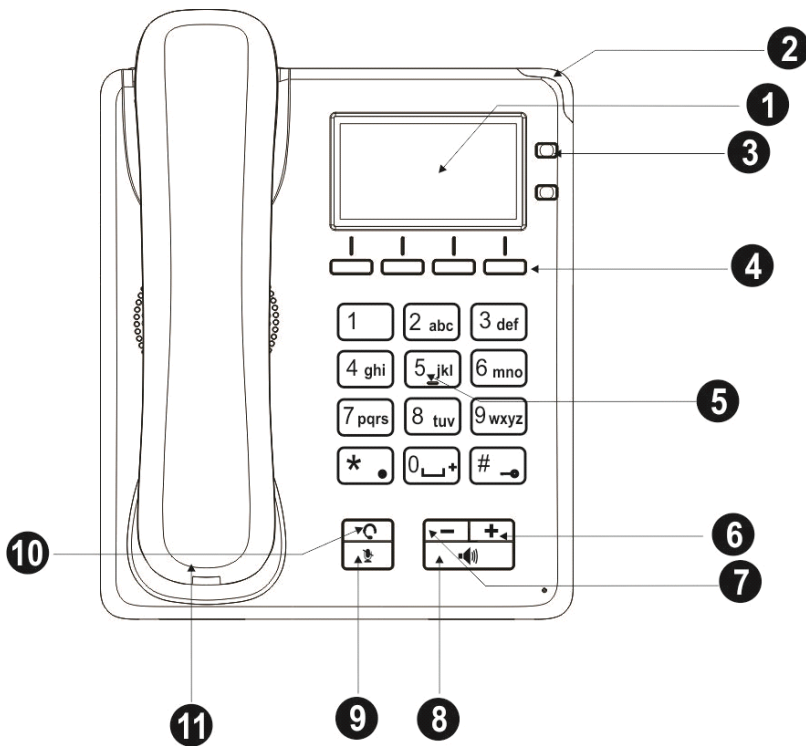

Know Your SPARSH VP210

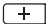

Number	Description
1	LCD Screen
2	Ringer LED
3	Navigation Key / SIP Line Key
4	Context Sensitive Key
5	Dial Pad
6	Volume Increase Key
7	Volume Decrease Key
8	Speaker Key
9	Mute
10	Headset Key
11	Handset

Volume Keys

While talking, Press  to increase and press  to decrease Speech volume.

When the phone rings, Press  to increase and press  to decrease Ringer volume.

Bottom View

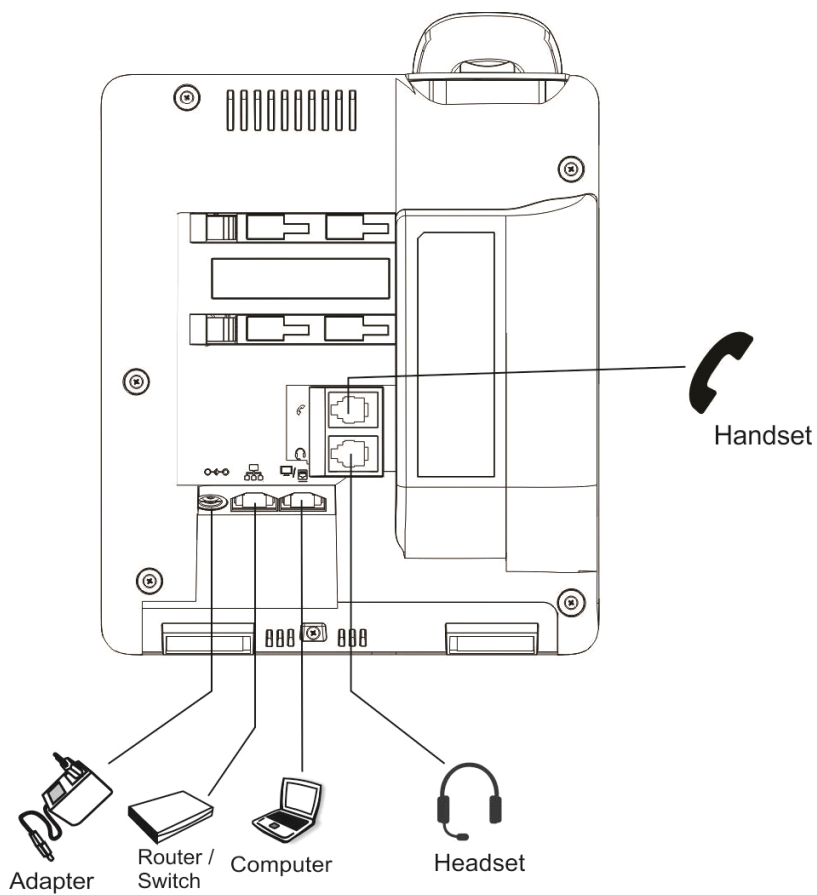

Installing SPARSH VP210

Mounting SPARSH VP210 on the Desk

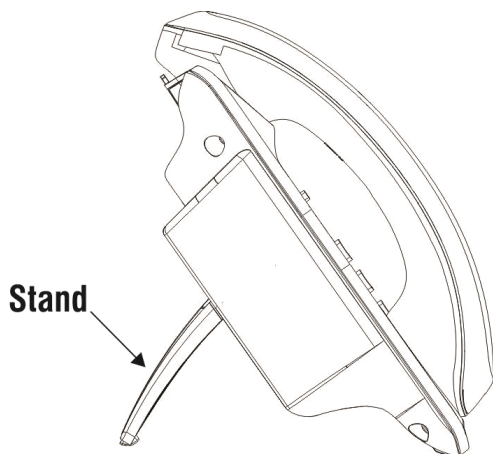

Attaching the Stand

You can attach the Stand in the following ways -

- at an angle of 45 degrees
- at an angle of 55 degrees

Foot Stand attached at 45 Degree Angle

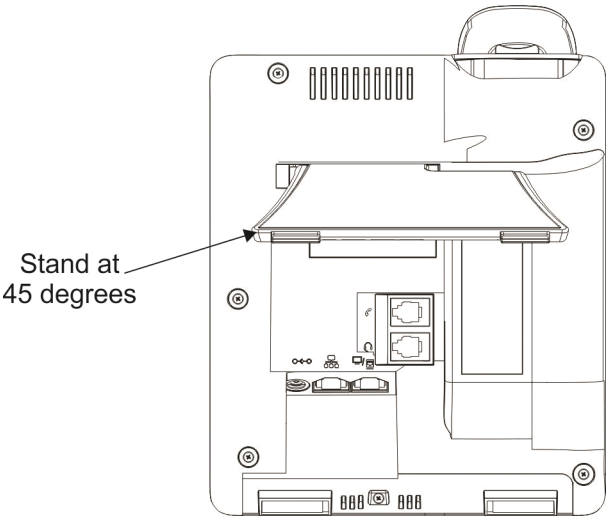

Foot Stand attached at 55 Degree Angle

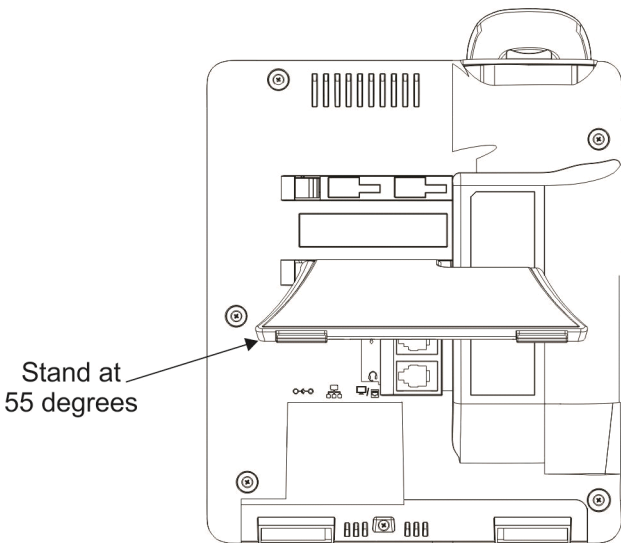

Connecting SPARSH VP210

Verify the Package Contents

Unpack the phone. Make sure that your package contains all the items as per the "[Package Contents](#)".

Get your Internet Connection ready

To install SPARSH VP210 you must have:

- Broadband Internet Connection to make/receive calls through Public Internet. If you want to make calls within your network, you do not need an Internet connection.
- A SIP Account with an Internet Telephony Service Provider (ITSP)/IP-PBX. If you want to make Peer-to-Peer calls (i.e. calls made without the intervention of a SIP/Proxy server), you do not need the services of an ITSP/IP-PBX.

Get your Network Information ready

Ask your LAN Administrator/ISP for:

- IP Address
- Subnet Mask
- Gateway Address
- DNS Address

Ask your ITSP for:

- SIP ID/User ID
- Authentication User ID (in most cases same as SIP ID)
- Authentication Password
- Registrar Server Address
- Registrar Server Port

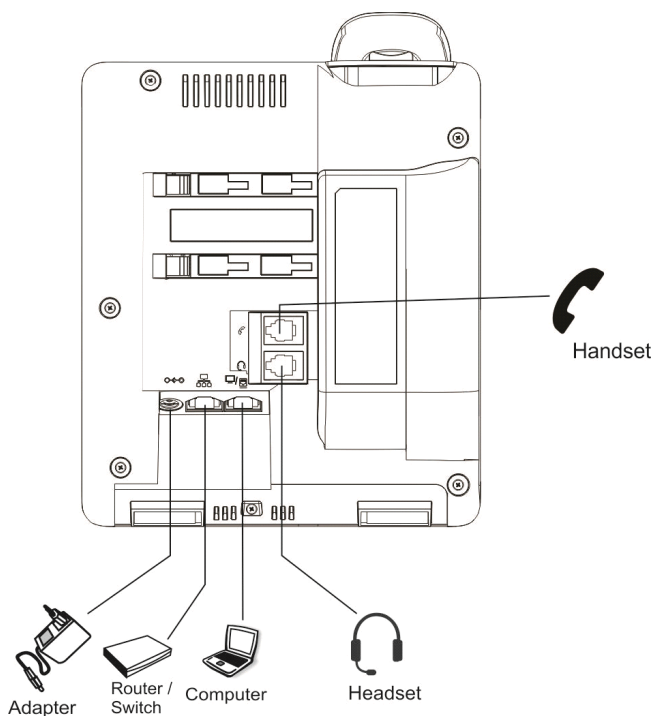

- Mount the phone on table at a location convenient to you.
- When you mount the phone on a desk, you can attach the Foot Stand in two ways — 45 degrees or 55 degrees. If you attach the Foot Stand at 55 degrees, the phone will be placed in an almost upright position on your desk. Decide which of these positions would work for you best and accordingly attach the Foot Stand.

Connect the Handset to the Phone body

- Connect the handset of the SPARSH VP210 to the phone body using the Spring Cord (supplied with the phone).
- Connect the long straightened end of the Spring Cord into the RJ9 connector at the bottom of the phone, marked with the symbol 

Connect a Headset (not supplied by Matrix)

- You may plug in a headset with RJ9 connector into the headset port at the bottom of the phone, marked with the symbol .

Connecting PC to the phone

- Plug in the Ethernet Cable into the PC Port  /  of the phone and the other end into the LAN Port of your PC/LAN Switch.

Connecting to IP Network

- Connect the LAN Port  of the phone to the IP Network — A Router or LAN Switch — using the Ethernet Cable.

Connecting Power Supply

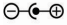
- Plug in the connector of the Adapter into the power jack (DC Jack)  at the bottom of the phone.
- Plug in the Power Adapter into a power outlet.



If you are going to use SPARSH VP210 in LAN environment and your LAN Switch supports Power over Ethernet (PoE as per IEEE 802.3af), do not connect the Adapter!

- Switch on the power supply.
- By default, the phone will boot in the Extended mode. To convert the mode to Standard, refer to [“Converting SPARSH VP210 Extended SIP Phone to SPARSH VP210 Standard SIP Phone”](#).



SPARSH VP210 with Serial Number: 10009001 and onwards only can be converted to Standard SIP Phones.

- The phone locates the IP Address. By default Dynamic IP Address is assigned to the phone.
- LCD appears in 'idle state, without a live network connection. Your SPARSH VP210 is now ready for configuration.

Configuring SPARSH VP210

SPARSH VP210 provides an embedded web server with a Graphic User Interface (GUI), *Jeeves*, for configuration. You can access this embedded web server on the PC connected to the PC port or LAN port.



You can configure Network Settings also from the Phone Menu. To do so,

- Press **Menu** Key.
- Scroll using the Up/Down Navigation Key to select **Settings** and press **Select** Key.
- Scroll using the Up/Down Navigation Key to select **Network Settings** and press **Select** Key.
- Scroll using the Up/Down Navigation Key to select **Connection Type** and press **Select** Key.
- Scroll using Right Navigation > Key or Left Navigation < Key, to select the **Connection Type** as Static.

To view the Dynamic IP Address assigned to the phone,

- Press **Menu** Key.
 - Scroll using the Up/Down Navigation Key to select **Phone Info** and press **Select** Key.
 - IP Address assigned to the phone is displayed. Take a note of the same.
- Make sure your PC is in the same Subnet as SPARSH VP210. Change the Subnet Mask of the PC, if necessary.
 - Open a web browser (Mozilla Firefox 90.0.2 or Google Chrome 96.0.4664.45 or Microsoft Edge 85.0.564.67) on the PC.
 - Enter the current IP Address of SPARSH VP210 in the address bar of the browser. Static Default: 192.168.001.016

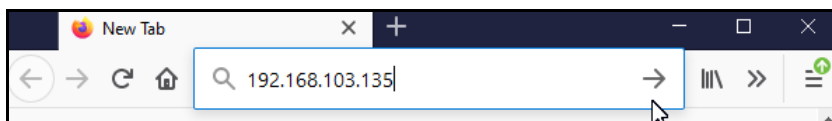

The Login page opens.

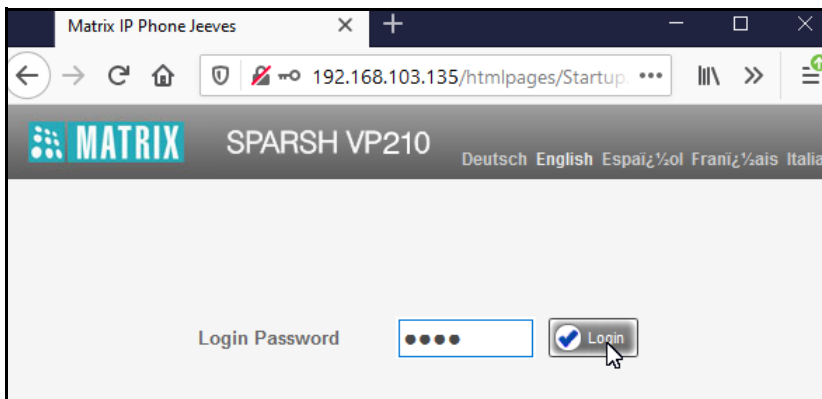

To configure SPARSH VP210,

- In the **Password** field, enter **1234**, the default configuration password.
- Click **Login** button.
- On successful login, the Home page appears.



The links Basic Settings, Advanced Settings, Certificate Management, Maintenance, Supplementary Services, and Status appear in the left pane.

Basic Settings are sufficient to get your SPARSH VP210 into operation.

To set up and operate your system, quickly,

- Click **Basic Settings** link.

The links to the different basic parameters appear on the left pane.

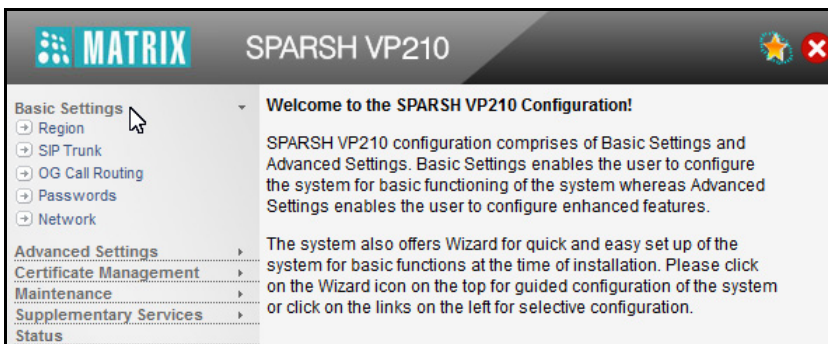

You may either use the *Wizard* to guide you through the configuration or selectively configure the *Basic Settings* pages.

When you use selective configuration,



- Click **Basic Settings** link to expand.
- Click each parameter link — **Region**, **SIP Trunk**, **Outgoing Call Routing**, **Passwords**, **Network**. The selected parameter page opens.
- Set the desired values on the page.
- Click **Submit** to save your settings on the page.

When you use the *Wizard*,

- Click the Wizard  icon on the top right of your screen.





- The **Next** button takes you to the next page, saving the changes you made on the current page.
- The **Back** button returns you to the previous page.
- The **More**  button expands parameters on the page.
- The **Less**  button collapses parameters on the page.
- The **Default** button assigns factory set values to all the parameters on the page.
- The **Quit**  button enables you to exit the Wizard at any stage, saving changes you made before exiting.

You may use the Wizard or selectively configure the Basic Settings pages, whichever works best for you. Read the User Guide for detailed instructions.

If required, you can convert the SPARSH VP210 Standard SIP Phone to SPARSH VP210 Extended SIP Phone. Refer to [“Converting SPARSH VP210 Standard SIP Phone to SPARSH VP210 Extended SIP Phone”](#) for details.

Converting SPARSH VP210 Extended SIP Phone to SPARSH VP210 Standard SIP Phone

By default the phone will boot in the Extended mode, follow the steps given below to convert the same to Standard mode:

- When the Phone is powered on and the Loading/Starting screen appears press #2. The following message appears.

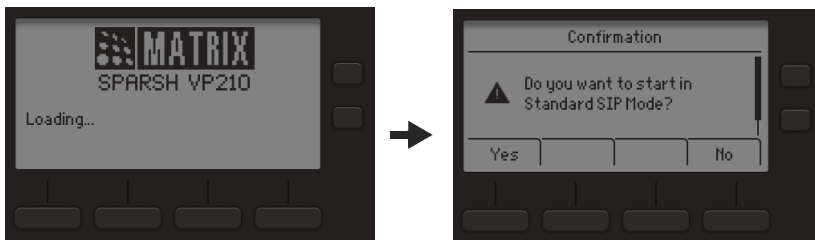

- Press **Yes** Key.

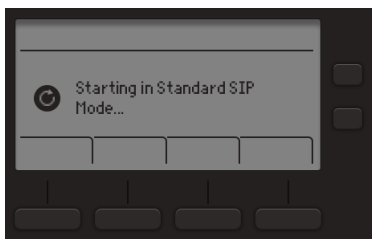

- The phone will reboot and start as a Standard SIP Phone. The Factory Default values for this mode will be assigned to all the parameters.

Converting SPARSH VP210 Standard SIP Phone to SPARSH VP210 Extended SIP Phone

To convert the SPARSH VP210 Standard SIP Phone to SPARSH VP210 Extended SIP Phone, follow the steps given below:



SPARSH VP210 with Serial Number: 10009001 and onwards only can be converted to Extended SIP Phones.

- When the Phone is powered on and the Loading/Starting screen appears press #2. The following message appears.

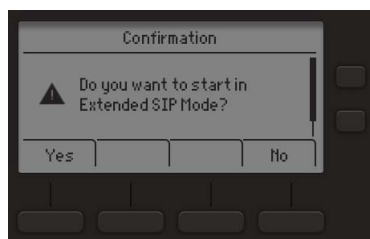

- Press **Yes** Key.

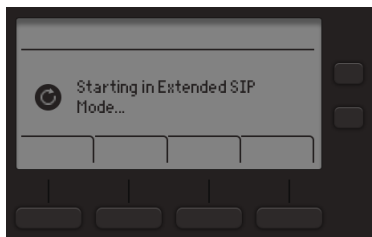

- The phone will reboot and start as an Extended SIP Phone. The Factory Default values for this mode will be assigned to all the parameters.

Refer to the SPARSH VP210 (Extended) User Guide and respective Server Manuals — SARVAM UCS, PRASAR UCS and ANANT UCS to know more. The documentation can be found at <http://www.matrixtelesol.com/product-manuals.html>.



MATRIX COMSEC

Head Office:

394-GIDC, Makarpura, Vadodara - 390010, India.

Tel.: +91 85111 73344

E-mail: Customer.Care@MatrixComSec.com

www.MatrixTeleSol.com